

21st JUNE - 11am

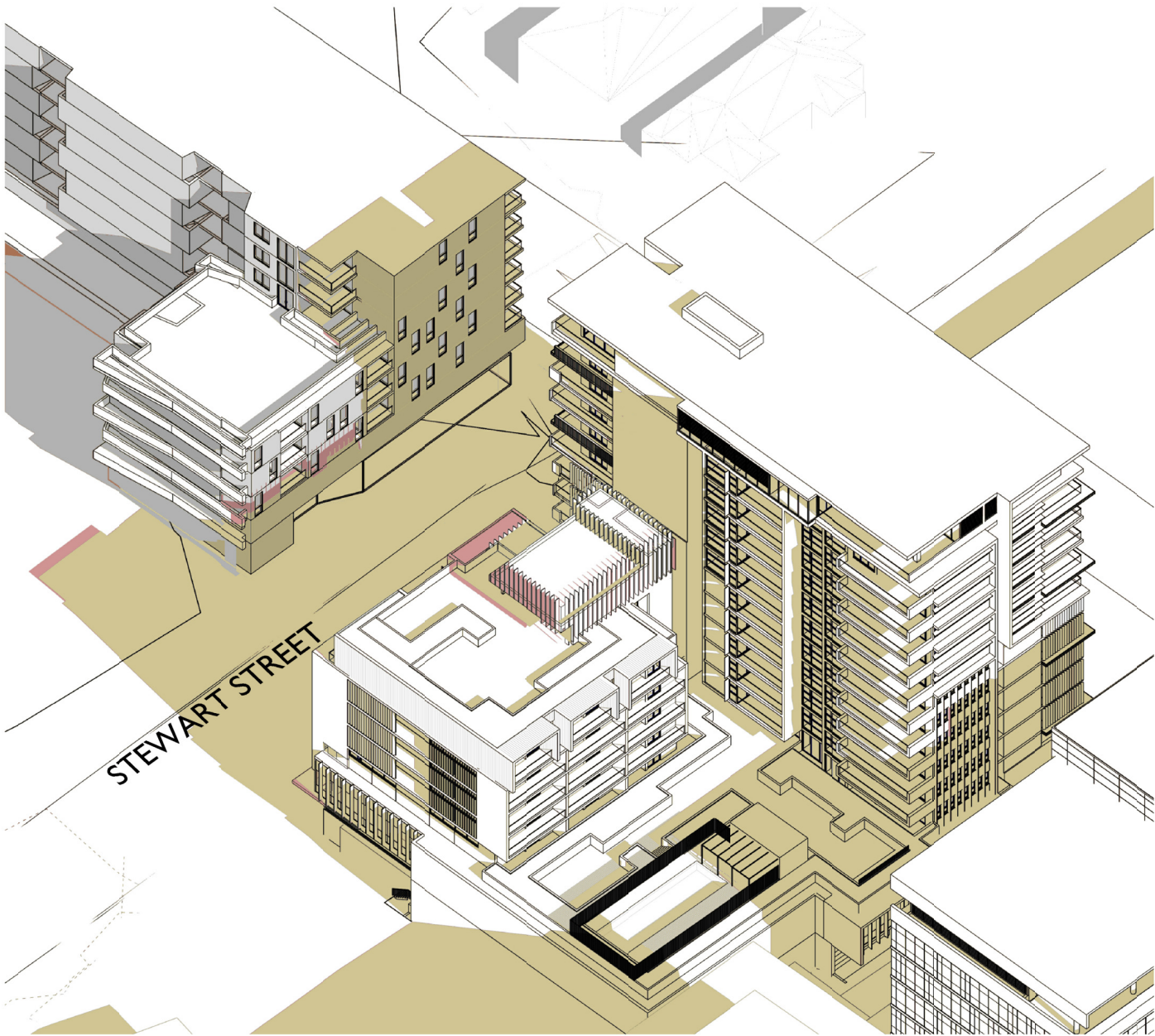

SOLAR IMPACT STUDY

© COPYRIGHT-These drawings remain the exclusive copyright of ADM Architects. Reproductions in any form whether electronic, digital or otherwise shall not be allowed except by express permission granted in writing by ADM Architects. Holders users and operators of these drawings require proof evidenced in writing that ADM Architects has written permission to use these drawings or shall otherwise be in breach of the Copyright Act and become liable accordingly.
FIGURED DIMENSIONS- These drawings are not to be scaled. Figured dimensions shall be used in all cases.
NOMINATED ARCHITECT- The nominated Architect for ADM Projects (Australia) Pty Ltd T/AS ADM Architects is Angelo Di Martino ARB No.7608

ISSUE	DATE	DESCRIPTION
A	20.12.18	ISSUED FOR DA
B	26.04.19	AMENDED FOR DA
C	06.12.19	AMENDED FOR DA

NOT FOR CONSTRUCTION

LEGEND

- EXISTING SHADOWS
- AMENDED PROPOSED SHADOWS
- PREVIOUSLY PROPOSED SHADOWS



94 Kembla St, Wollongong NSW 2500 PO Box 3061 Wollongong
ph: 02 4228 6400 fax: 02 4221 6455 www.admarchitects.com.au

Project
PROPOSED MIXED USE BUILDING
COMPRISING OF RESIDENTIAL APARTMENTS
ABOVE COMMERCIAL PREMISES
AND CARPARKING

At
LOT 502, D.P. 845275
CORNER KEMBLA AND STEWART STREET
WOLLONGONG
For

CITY INVESTMENTS PTY. LTD

Title
DEVELOPMENT APPLICATION
SOLAR IMPACT STUDY - 11am

Scale NTS	Date DECEMBER 2019	
Drawn LGD SJ	Checked ADM	
Project No. 2017-02	Drawing No. A405.1	Issue C